

CATALOG NUMBER	DESCRIPTION
1200-2300	CONVOLUTED BOTTOM, PP, NON-STERILE
1200-2301	CONVOLUTED BOTTOM, PP, STERILE

CATALOG NUMBER.....:	SEE ABOVE	
NOM. CAP (mL).....:	300	
MATERIAL.....:	PP	
	INCH	MM
A (BASE LENGTH).....:	5.03	127.8
B (BASE WIDTH).....:	3.365	85.5
C (TOP LENGTH).....:	4.88	123.8
D (TOP WIDTH).....:	3.22	81.7
E (STEP HEIGHT).....:	.10	2.5
F (OVERALL HEIGHT).....:	1.57	39.9
G (BOTTOM OF WELL DISTANCE).....:	.10	2.5
H A-1 LOCATION (X).....:	0.57	14.4
J A-1 LOCATION (Y).....:	0.44	11.2
K WELL TO WELL SPACING.....:	0.36	9.0

1. ALL DIMENSIONS ARE NOMINAL AND IN INCHES AND MILLIMETERS UNLESS OTHERWISE NOTED.
2. THIS IS NOT A PRODUCTION DRAWING, BUT IS FOR INFORMATIONAL PURPOSES ONLY, AND IS SUBJECT TO CHANGE WITHOUT NOTICE.

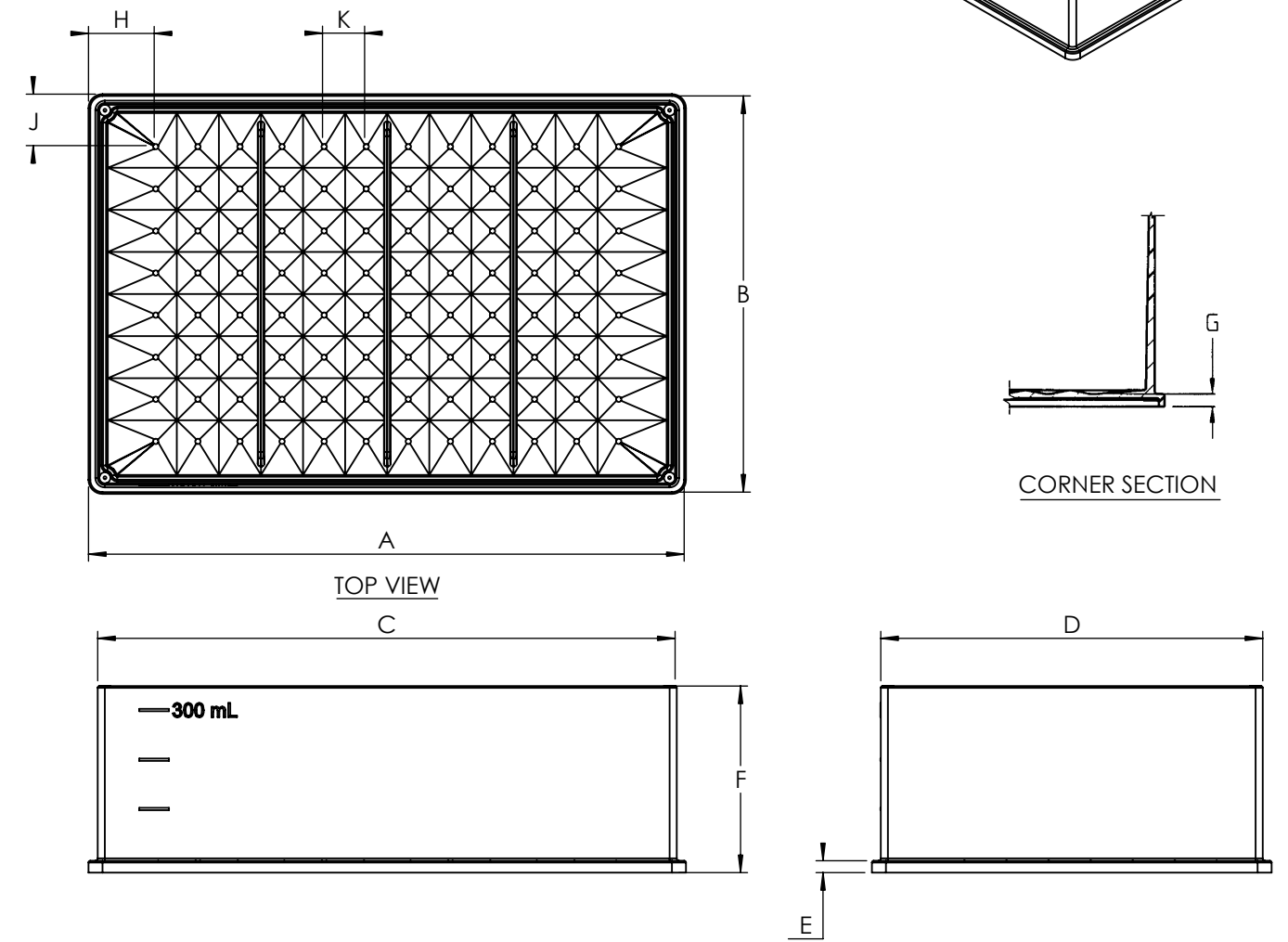

SPECS ON BACK

NOT TO SCALE

CONFIDENTIAL

THIS PRODUCT SPECIFICATION SHEET CONTAINS CONFIDENTIAL AND/OR PROPRIETARY INFORMATION AND IS TO BE USED ONLY FOR THE EXPRESSED PURPOSES AGREED UPON BY AN AUTHORIZED OFFICER OF THERMO FISHER SCIENTIFIC.

ThermoFisher
SCIENTIFIC

Thermo Fisher Scientific
75 Panorama Creek Drive
Rochester, NY 14625-2385, USA

MADE MCC	APP'D PVC	PSS 120023XX	REV.
CK'D RDR 2/20/02	2/20/02		0202

DESCRIPTION: ROBOTIC RESERVOIR, PP, CONVOLUTED BOTTOM